

**Broadband Butterfly Terminated Dipole (BBTD)**

1.8-54MHz HF Antenna  
 Mounted around perimeter of roof's shingles w/ christmas light clips

1 Story Ranch  
 (~10' off ground)



Wire run along drip edge of shingles right above gutters

16:1 Balun  
 CB-16-1-1500EB/TS  
 Mounted under soffit

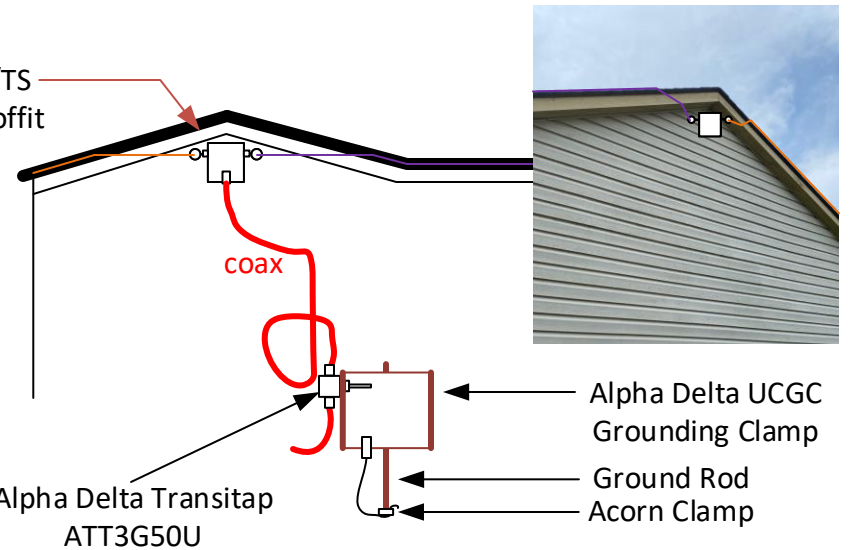

Alpha Delta Transitap  
 ATT3G50U

Alpha Delta UCGC  
 Grounding Clamp  
 Ground Rod  
 Acorn Clamp

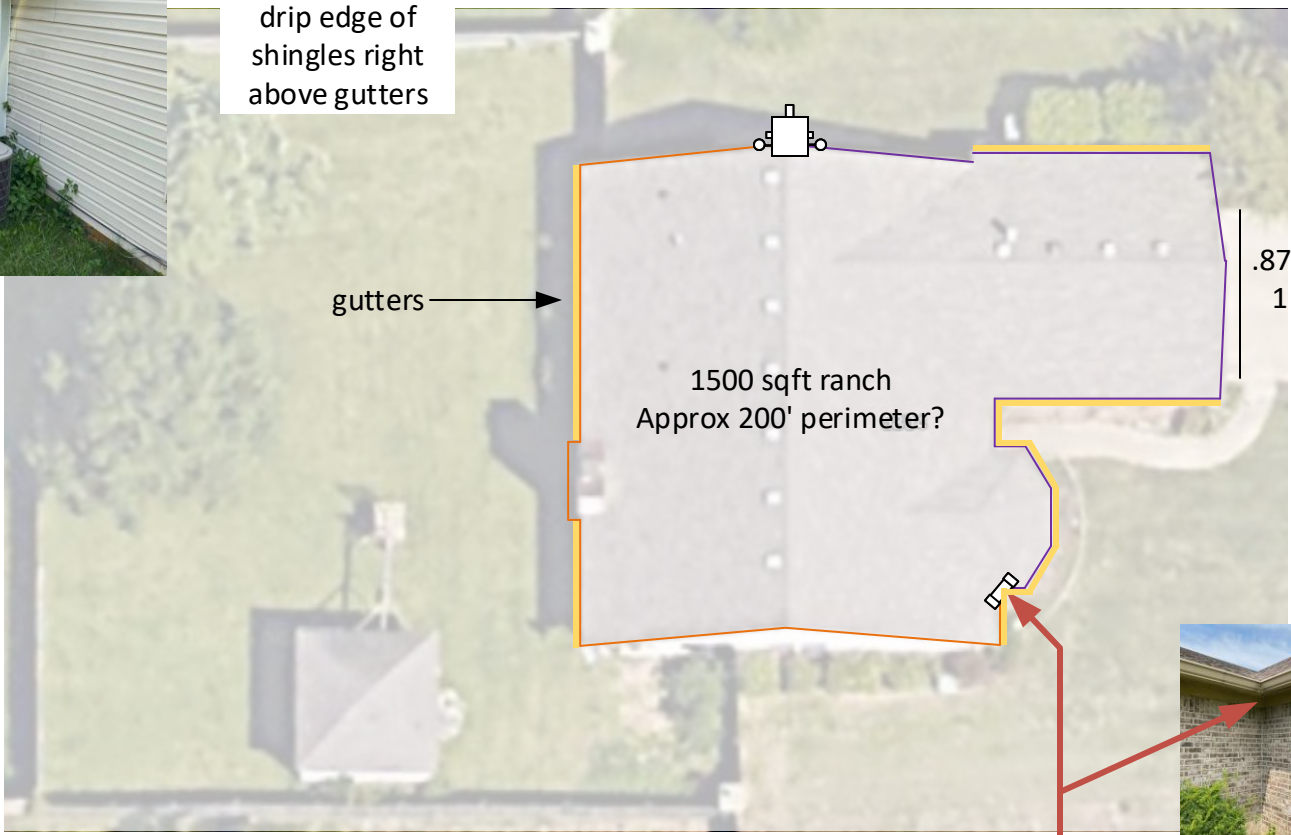

gutters

1500 sqft ranch  
 Approx 200' perimeter?

.875 = 168"  
 1 = 192"

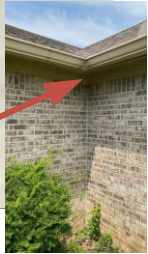

1000 Ohm Termination Resistor  
 TR-1000-600  
 Mounted under the soffit

DX10 14 AWG

1.072 * 1.06 = 1.14
1.442
.063
.406
.063
.656
1.067 * 1.06 = 1.13
1.129 * 1.06 = 1.20
.2
-----
6.3 x 192"
1209" = 100'

DX10 14 AWG

.989 * 1.06 = 1.05
1.234
.600 * 1.15 = 0.69
.600 * 1.15 = 0.69
1.175
.277
.16
.256
.3
.256
.129
-----
6.217 x 192"
1193" = 99.5'

- Parts List
- DX Engr ~200' DX10 14AWG \$100
  - Palomar Engr TR-1000-600 \$100
  - Palomar Engr CB-16-1-1500EB/TS \$140
  - Christmas Light Clips
  - Coax
  - Grounding Rod
  - Alpha Delta UCGC Ground Clamp \$55
  - Alpha Delta ATT3G50U Lightning Arrester \$69
  - Jet Lube SS-30 Pure Copper AntiSieve \$32